

- 2.25 inch (57.15 mm) square NEMA 23
- Continuous Torques up to 60 lb-in (6.78 Nm)
- Peak Torques up to 90 lb-in (10.17 Nm)
- Ratios 5, 10, 15, 25, 50 & 100 Standard
- "Clamp On" Pinion
- Low Cost Powder Metal Gearing Assembly
- 75 lbs. (34 kg) Radial and Axial Load Capacity
- "Bolt On" to NEMA 23 Motors

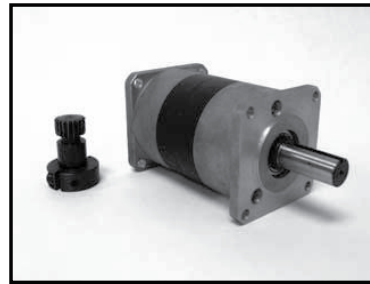

| Specification     | Units  | Part/ Model Number |        |        |        |        |        |
|-------------------|--------|--------------------|--------|--------|--------|--------|--------|
|                   |        | G3005              | G3010  | G3015  | G3025  | G3050  | G3100  |
| Exact Ratio       | -      | 5                  | 10     | 15     | 25     | 50     | 100    |
| Continuous Torque | lb-in  | 60                 | 60     | 60     | 60     | 60     | 60     |
|                   | Nm     | 6.779              | 6.779  | 6.779  | 6.779  | 6.779  | 6.779  |
| Peak Torque       | lb-in  | 90                 | 90     | 90     | 90     | 90     | 90     |
|                   | Nm     | 10.169             | 10.169 | 10.169 | 10.169 | 10.169 | 10.169 |
| Speed Max Output  | RPM    | 800                | 400    | 267    | 160    | 80     | 40     |
| Speed Max Input   | RPM    | 4000               | 4000   | 4000   | 4000   | 4000   | 4000   |
| Stages            | -      | 1                  | 2      | 2      | 2      | 3      | 4      |
| Efficiency        | -      | 90%                | 80%    | 80%    | 80%    | 70%    | 60%    |
| Max Length        | Inches | 2.97               | 3.55   | 3.87   | 3.87   | 4.45   | 5.05   |
|                   | mm     | 75.4               | 90.2   | 98.3   | 98.3   | 113    | 128.3  |
| Weight            | Lbs    | .9                 | 1.3    | 1.8    | 1.8    | 2.2    | 2.6    |
|                   | Kg     | 0.4                | 0.6    | 0.8    | 0.8    | 1      | 1.2    |

1) Backlash accuracy will be typically less than 3 Deg., 2) Add gear length to motor length

| Typical Combinations                    |            | Voltage VDC | Motor Length mm / in | Perform | Units      | Gear Ratios |           |           |          |          |          |
|---|------------|-------------|----------------------|---------|------------|-------------|-----------|-----------|----------|----------|----------|
| Gear #                                  | Motor #    |             |                      |         |            | 5           | 10        | 15        | 25       | 50       | 100      |
| <b>Brushless Gearmotor Combinations</b> |            |             |                      |         |            |             |           |           |          |          |          |
| G3xxx -                                 | I2352048NC | 20          | 90.4 / 3.56          | Speed   | rpm        | 800         | 400       | 267       | 160.0    | 80.0     | 40.0     |
|   |            |             |                      | Tc      | Nm / lb-in | 0.89 / 7.9  | 1.58 / 14 | 2.37 / 21 | 4 / 35   | 6.8 / 60 | 6.8 / 60 |
|   |            |             |                      | lc      | amps dc    | 5.1         | 5.1       | 5.1       | 5.1      | 5.0      | 2.90     |
| G3xxx -                                 | I2381088NC | 36          | 80 / 3.15            | Speed   | rpm        | 800         | 400       | 267       | 160.0    | 80.0     | 40.0     |
|   |            |             |                      | Tc      | Nm / lb-in | 0.64 / 5.6  | 1.13 / 10 | 1.69 / 15 | 2.8 / 25 | 4.9 / 44 | 6.8 / 60 |
|   |            |             |                      | lc      | amps dc    | 2.0         | 2.0       | 2.0       | 2.0      | 2.0      | 1.58     |
| G3xxx -                                 | I2383092NC | 40          | 119.9 / 4.72         | Speed   | rpm        | 800         | 400       | 267       | 160.0    | 80.0     | 40.0     |
|   |            |             |                      | Tc      | Nm / lb-in | 1.85 / 16.3 | 3.28 / 29 | 4.92 / 44 | 6.8 / 60 | 6.8 / 60 | 6.8 / 60 |
|   |            |             |                      | lc      | amps dc    | 5.5         | 5.5       | 5.5       | 4.5      | 2.6      | 1.51     |
| G3xxx -                                 | I2383214NC | 80          | 119.9 / 4.72         | Speed   | rpm        | 748         | 374       | 249       | 149.5    | 74.8     | 37.4     |
|   |            |             |                      | Tc      | Nm / lb-in | 1.85 / 16.3 | 3.28 / 29 | 4.92 / 44 | 6.8 / 60 | 6.8 / 60 | 6.8 / 60 |
|   |            |             |                      | lc      | amps dc    | 2.4         | 2.4       | 2.4       | 2.0      | 1.1      | 0.65     |
| G3xxx -                                 | I2384124NC | 50          | 140 / 5.51           | Speed   | rpm        | 800         | 400       | 267       | 160.0    | 80.0     | 40.0     |
|   |            |             |                      | Tc      | Nm / lb-in | 2.64 / 23.4 | 4.69 / 42 | 6.78 / 60 | 6.8 / 60 | 6.8 / 60 | 6.8 / 60 |
|   |            |             |                      | lc      | amps dc    | 5.8         | 5.8       | 5.6       | 3.4      | 1.9      | 1.12     |

Notes 1) Many other gearmotor combinations exist - consult factory, 2) Add Gear & Motor length 3) Add ratio value to G3 Model number as in chart above

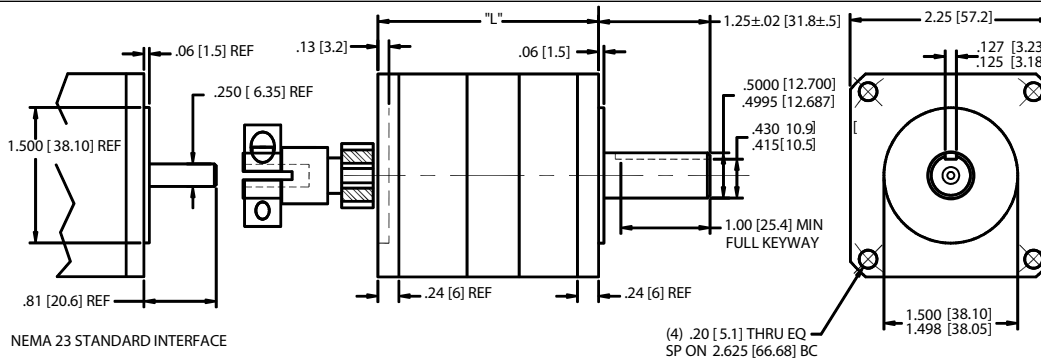

This document is for informational purposes only and should not be considered as a binding description of the products or their performance in all applications. The performance data on this page depicts typical performance under controlled laboratory conditions. Actual performance will vary depending on the operating environment and application. AMETEK reserves the right to revise its products without notification. The above characteristics represent standard products. For products designed to meet specific applications, contact PITTMAN Motor Sales Department.